

## Air Jet Nozzle Round type



Low noise level



● 303 Stainless steel  
KSVR



● Aluminum  
KAVR



● Brass  
KBVR



## Shapes and dimensions

《KBVR type》

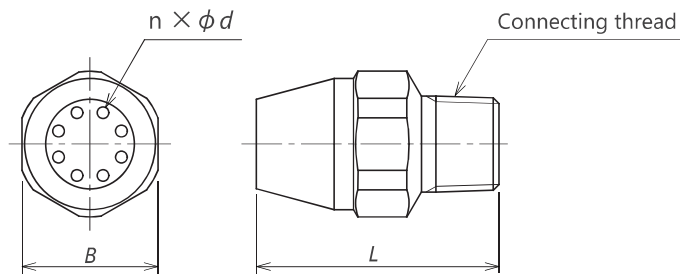

Model	Model No.	Q'ty of orifice $n$	Dimensions [mm]			Connecting thread	Max. service pressure [MPa]	Max. air flow rate [L/min(nor)]	Heatproof temp. [°C]	Weight [g]
			$d$	$B$	$L$					
KSVR	1	6	1.0	14	25	R $\frac{1}{8}$	0.7	360	250	13
	2	8	1.0	14	25	R $\frac{1}{8}$	0.7	475	250	13
	3	6	1.0	14	25	R $\frac{1}{4}$	0.7	360	250	15
KBVR	4	8	1.0	14	25	R $\frac{1}{4}$	0.7	475	250	15
	5	6	1.4	17	32	R $\frac{1}{4}$	0.7	700	250	28
KAVR	6	8	1.4	17	32	R $\frac{1}{4}$	0.7	930	250	28

● The values of heatproof temperature and weight are based on stainless steel material.

● Model and model number representing

K S V R

Material

S - Stainless steel

B - Brass

A - Aluminum

1

Model No.

## Performance data

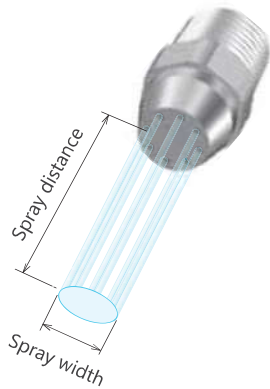

### Spray width characteristics

Model	Model No.	Air pressure [MPa]	Spray widths [mm] at the following spray distances [mm]					
			50	100	300	500	1000	1500
KSVR KBVR KAVR	1 3	0.1	10	18	64	115	250	380
		0.3	12	21	72	125	260	390
		0.5	13	22	73	130	265	395
	2 4	0.1	11	19	67	120	255	390
		0.3	12	22	73	130	265	400
		0.5	13	23	74	135	275	410
	5	0.1	12	17	67	118	255	380
		0.3	13	23	73	130	260	390
		0.5	14	24	74	132	265	395
6	0.1	13	19	68	120	255	390	
	0.3	14	23	75	130	265	400	
	0.5	15	25	77	135	275	410	

### Air velocity characteristics

Measurement position : Center of spray      Spray direction : Horizontal

Model	Model No.	Air pressure [MPa]	Air velocity [m/s] at the following spray distances [mm]					
			50	100	300	500	1000	1500
KSVR KBVR KAVR	1 3	0.1	58	40	14	10	4	3
		0.3	85	63	26	16	8	5
		0.5	106	81	33	21	10	7
	2 4	0.1	66	48	17	11	5	3
		0.3	96	73	31	19	9	6
		0.5	117	90	40	25	12	8
	5	0.1	77	58	22	14	7	4
		0.3	112	86	38	23	11	8
		0.5	132	103	50	30	14	10
6	0.1	85	65	26	15	7	5	
	0.3	123	96	43	27	13	9	
	0.5	143	113	56	35	16	12	

### Air flow rate characteristics

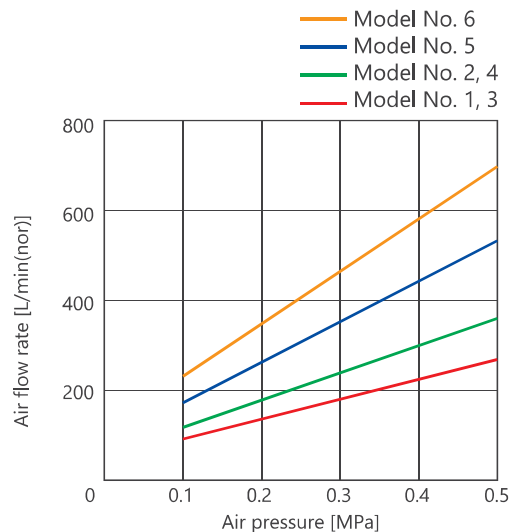

### Noise level characteristics

Measurement position : 1 m above the floor, 1 m distance

Background noise : 45 dB

Spray direction : Horizontal

Model	Model No.	Equivalent sound levels [dB] at the following air pressures [MPa]		
		0.1	0.3	0.5
KSVR KBVR	1, 3	54	68	74
	2, 4	58	71	78
KAVR	5	62	75	83
	6	65	78	86